

HYDRAULIC EJECTORS

- Double effect Hydraulic Ejectors
- Suitable for hot stamping
- HSE standard size
- HSCE compact size
- Anti-ejection device
- Non-rotating device



HSE

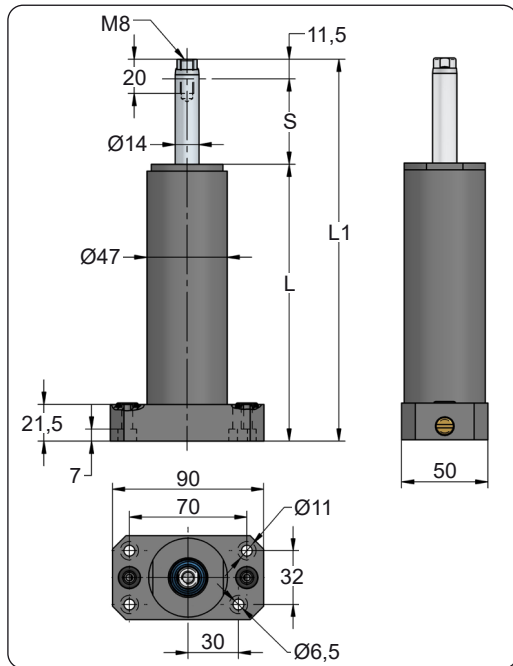

Hydraulic Ejector

**AZOL
GAS**

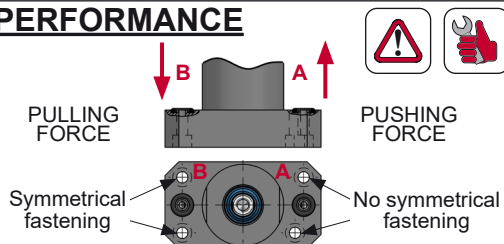
ORDER	S (mm)	L1 $\pm 0,25$ (mm)	L (mm)
HSE 15-30 025	25	173.5	137
HSE 15-30 050	50	223.5	162
HSE 15-30 075	75	273.5	187
HSE 15-30 100	100	323.5	212
HSE 15-30 125	125	373.5	237
HSE 15-30 150	150	423.5	262
HSE 15-30 175	175	473.5	287
HSE 15-30 200	200	523.5	312
HSE 15-30 225	225	573.5	337
HSE 15-30 250	250	623.5	362

PERFORMANCE

WARNING: no symmetrical fastening (A) corresponds to pushing force and symmetrical fastening (B) corresponds to pulling force.

		
Pmax (bar)	Pmax (psi)	Pushing Force (N)
100	1450	4909
		Pulling Force (N)
		3369

ENG ORDER	DEU BESTELL	FRA COMMANDE	ITA ORDINE	ESP PEDIDO	POR PEDIDO
HSE 15-30					
HSE 15-30 050					

 **50** mm

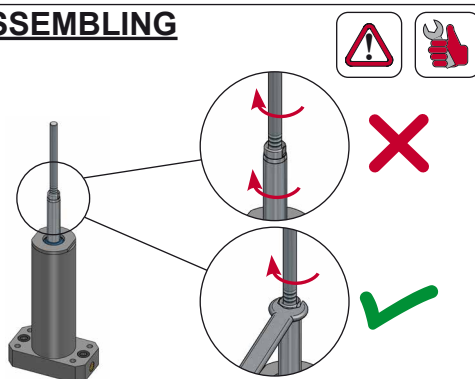
ASSEMBLING

WARNING: when threading ejector rods to the HSE hydraulic ejector, the HSE piston rod must be well fastened as shown to prevent its rotation.

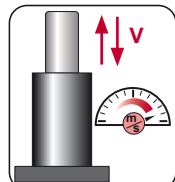
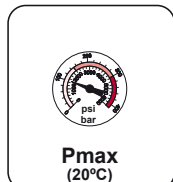
**OIL****Vmax 0,5 m/s**

bar **psi**
100 1450

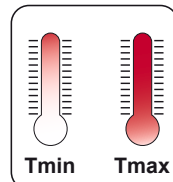

Tmin **Tmax**
°C °F °C °F
0 32 80 176

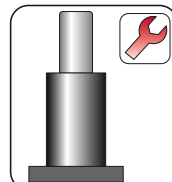
**NO REPAIR**

CONNECTION



1 SUPERIOR

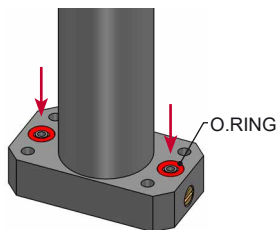
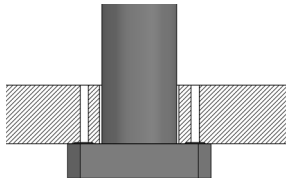

WARNING: Only one type of connection (superior) is available.

Use the o.rings supplied with HSE to connect the hydraulic ejector HSE to the plate.

HOW TO ORDER

	ENG ORDER
	DEU BESTELL
	FRA COMMANDE
	ITA ORDINE
	ESP PEDIDO
POR PEDIDO	

HSE 15-30

50 mm

HSE 15-30 050



WARNING:

Due to only one type of connection (superior) is available, HSE hydraulic ejector is supplied with the corresponding o.rings (on separate bag fitted to the cylinder).

HSCE V1

Hydraulic Ejector

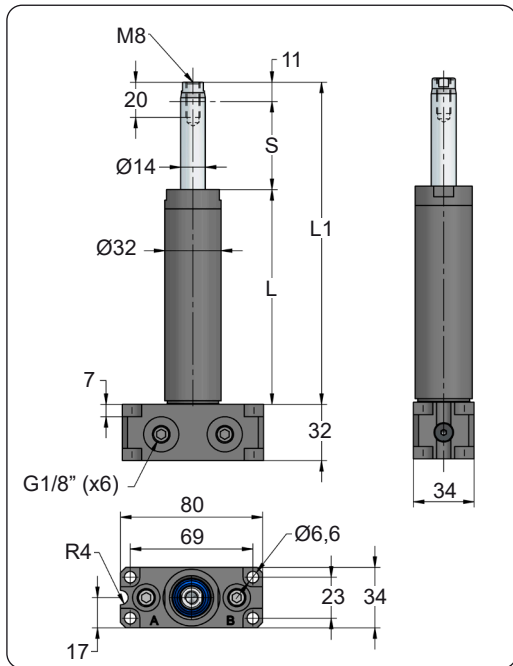

ORDER	S (mm)	L1 ±0,25 (mm)	L (mm)
HSCE 45-45 025 V1	25	133	97
HSCE 45-45 050 V1	50	183	122
HSCE 45-45 075 V1	75	233	147
HSCE 45-45 100 V1	100	283	172
HSCE 45-45 125 V1	125	333	197
HSCE 45-45 150 V1	150	383	222
HSCE 45-45 175 V1	175	433	247
HSCE 45-45 200 V1	200	483	272
HSCE 45-45 250 V1	250	583	322

PERFORMANCE

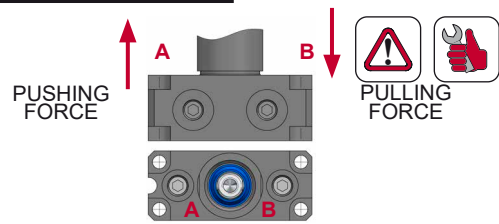

WARNING: fastening (A) corresponds to pushing force and fastening (B) corresponds to pulling force.

Pmax (bar)	Pmax (psi)	Pushing Force (N)	Pulling Force (N)
100	1450	4626	4626

ASSEMBLING

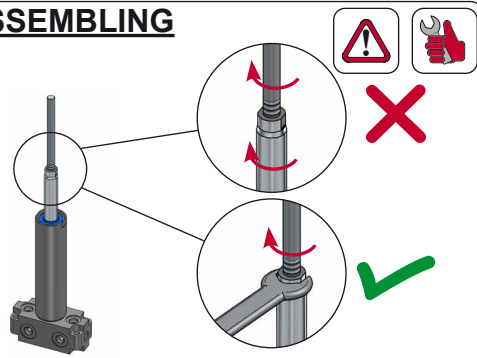

WARNING: when threading ejector rods to the HSCE hydraulic ejector, the HSCE piston rod must be well fastened as shown to prevent its rotation.

ENG ORDER
 DEU BESTELL
 FRA COMMANDE
 ITA ORDINE
 ESP PEDIDO
 POR PEDIDO

HSCE 45-45
HSCE 45-45 050 V1

S
 mm



OIL

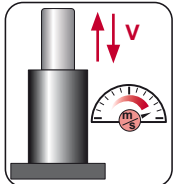

Vmax 0,5 m/s

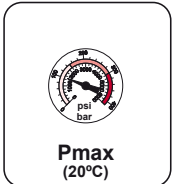

bar psi
100 1450

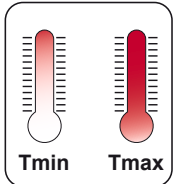

°C °F °C °F
0 32 80 176



NO REPAIR

CONNECTION

1 SUPERIOR

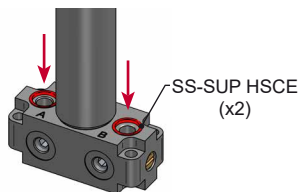
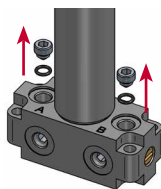
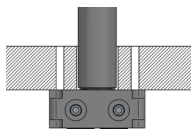
INCLUDED

2 INFERIOR

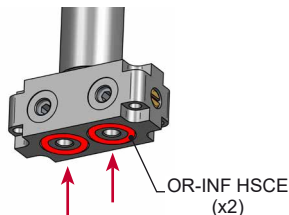
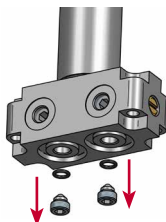
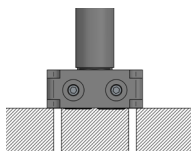
INCLUDED

3 LATERAL

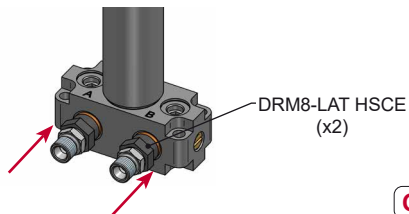
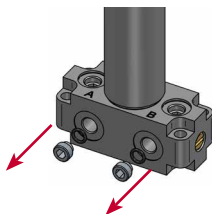
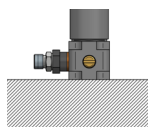
OPTIONAL

WARNING: there are 3 types of connection

- 1.SUPERIOR. Remove the screw and the o.ring. Use the new SS-SUP HSCE to seal the HSCE to the plate.
- 2.INFERIOR. Remove the screw and the o.ring. Use the new OR-INF HSCE to seal the HSCE to the plate.
- 3.LATERAL. Remove the screw and the o.ring. No o.ring is used, just thread DRM8-LAT HSCE to the HSCE.

HOW TO ORDER

	ENG ORDER
	DEU BESTELL
	FRA COMMANDE
	ITA ORDINE
	ESP PEDIDO
POR PEDIDO	



HSCE 15-30

50

HSCE 15-30 050 V1

Options:

3 Lateral

DRM8-LAT HSCE

WARNING:

Due to the different types of connections, HSCE hydraulic ejector is supplied with all the sealing plugs assembled and the sealing o.rings SS-SUP HSCE and OR-INF HSCE (on separate bag fitted to the cylinder). Adapter DRM8-LAT HSCE must be ordered separately as an option.



Landalucía, 7, P.I. Júndiz
01015 Vitoria-Gasteiz
Tel.: +34 945 290 010
Fax: +34 945 290 381

azolgas@azolgas.com
www.azolgas.com